



**Technical Service  
Information Bulletin**

August 10, 2007

Title:

# INITIALIZATION OF FRONT MEMORY SEAT ECU DURING PDS

Models:

'08 LS 460

PRE-DELIVERY SERVICE  
PD040-07

**Introduction** As a result of the removal of the DCC fuses (No. 1 and No. 2), the “driving position memory” function of the driver’s seat will be inoperative due to loss of the seat position memory stored in the seat ECU.

Initialize the front memory seat ECU after installing the DCC fuses during Pre-Delivery Service (PDS).

- Applicable Vehicles**
- 2008 model year **LS 460** vehicles.

**Warranty Information**

OP CODE	DESCRIPTION	TIME	OFF	T1	T2
N/A	Not Applicable to Warranty	—	—	—	—

**Driver’s Seat Initialization Procedure**

1. Turn the ignition switch to the “IG-ON” position, operate the vertical height switch to the lower side 3 times.  
Within 10 seconds, simultaneously operate the seatback angle switch to the rear side and the vertical height switch to the lower side until a beep is heard.

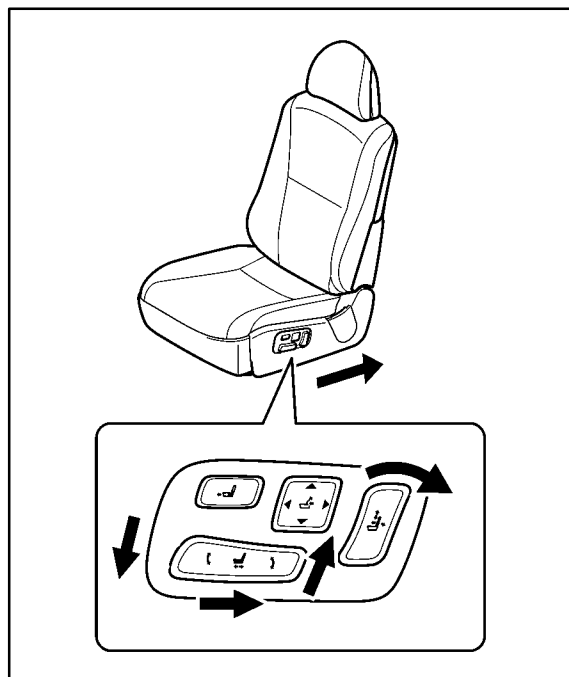

**Driver's Seat  
Initialization  
Procedure**  
(Continued)

2. Operate the slide control switch to the rearmost position.

**NOTE:**

**When operating the control switch, the warning buzzer sounds.**

After operating the slide control switch, the following operations will occur automatically:

- The head restraint automatically moves to the uppermost position and a beep is heard.
- The seat cushion length automatically slides to the rearmost position and a beep is heard.

**HINT:**

**The two seat operations described above occur simultaneously.**

3. Move the seatback angle switch forward until a beep is heard.

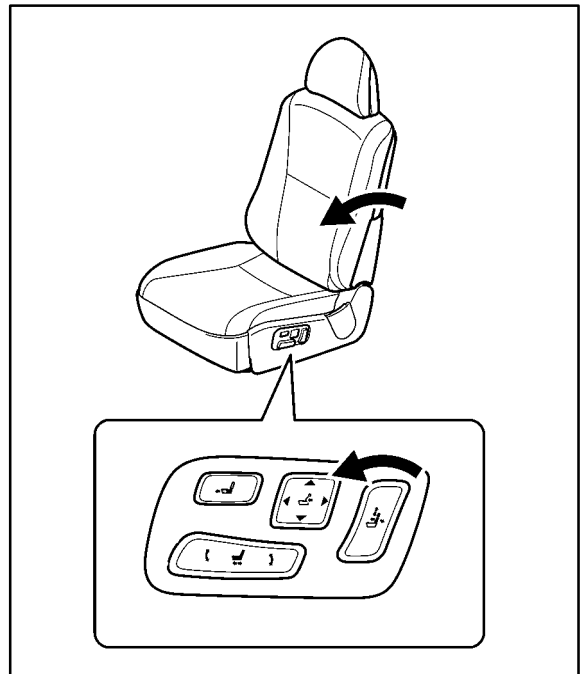
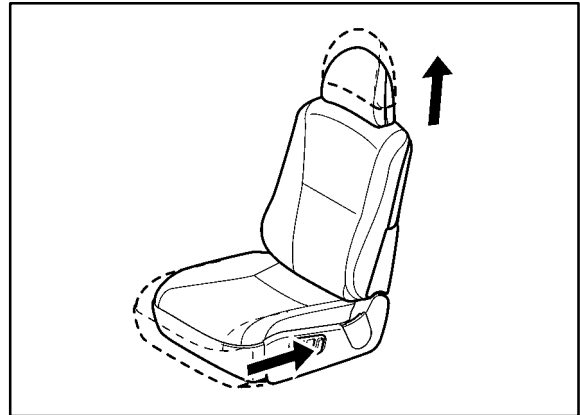

**Driver's Seat  
Initialization  
Procedure**  
(Continued)

4. Operate the head restraint height adjustment switch and check that the head restraint moves to the uppermost and lowermost positions normally. (Refer to "1" in the illustration.)
5. Operate the seat position control switch and check that the seat slides forward and rearward and that the beep is NOT heard. (Refer to "2" in the illustration.)

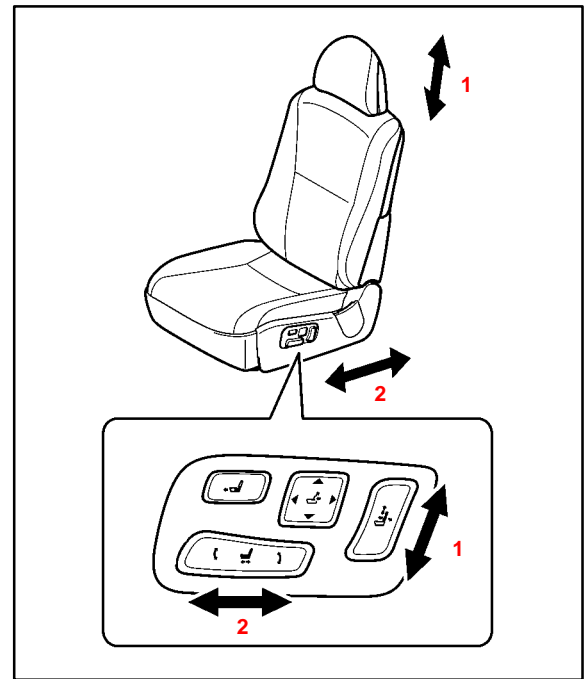

**Front  
Passenger's  
Seat  
Initialization  
Procedure**

1. Simultaneously operate the seatback angle switch to the rear side and the height adjustment switch to the lower side until a beeping sound is heard. Within 10 seconds, simultaneously operate the seatback angle switch to the rear side and the vertical height adjustment switch to the lower side until a beep is heard.
2. Operate the slide control switch to the rearmost position.

**NOTE:**

When operating the control switch, the warning buzzer sounds.

After operating the seat position control switch, the following operations will occur automatically:

- The head restraint automatically moves to the lowermost position and a beep is heard.
- The seat vertical height automatically moves to the uppermost or lowermost position and a beep is heard.

**HINT:**

The two seat operations described above occur simultaneously.

